

PLEASE CHECK YOUR CAR BEFORE ORDERING

*This is the first step you should take after you purchase the car!!!
You will notice that we do not carry master cylinder "kits" or wheel
cylinder "kits" - Don't trust your brakes on a "kit"!!! These are new
- not rebuilt - "Quality" parts - Remember, you get what you pay for-
This is one area you do not want to scrimp on.*

MASTER CYLINDER BOOT

*1960-70 0A2180..... 5.00

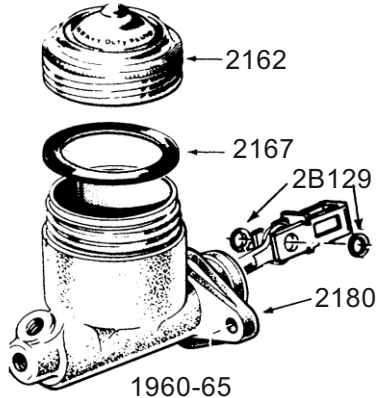

MASTER CYLINDER - NEW - NOT REBUILT!

	Manual Drum	
1960-65*	MC32900	65.00
1966*	MC36208	80.00
1967-70*	MC39495	85.00
	Power Drum	
1964-65	MC36095	75.00
1967-70	MC36248	75.00
	Disc	
1968-70	MC36251	75.00
For cars with Granada disc brakes use		
	MC36440	85.00

**NOS Master Cylinders
W/ copper domed cap
1960-64 C3AZ2140B
\$90.00 WHILE THEY
LAST!**

**Copper Cap Only -
Not Perfect!
C0AZ2162A \$40.00
WHILE THEY LAST!**



*MASTER CYLINDER CAP

1960-66 Drum - zinc w/ gasket C5ZZ2162BR..... 15.00
1960-66 Drum - chrome w/ gasket C5ZZ2162CHR..... 20.00
1967-70 Disc - chrome C7AZ2162CR..... 18.00



*MASTER CYLINDER CAP GASKETS

1967-70 Drum C7AZ2167A..... 4.50
1967-70 Disc C7AZ2167B..... 4.50

MASTER CYLINDER PUSH ROD RETAINER

1966 up C7AZ2B224B..... 5.25

MASTER CYLINDER ROD SPACER

1965 up C5DZ2B129B..... 2.00

MASTER CYLINDER ROD BUSHING

*1960-64 B2A2474A..... 3.00
*1965-68 C5DZ2474B..... 3.50
1969-70 C9AZ2474A..... 3.00



POWER BRAKE BOOSTER CHECK VALVE

1969-70 Bendix - Disc D0AZ2365A..... 11.50

***Also fits Comet**

POWER BRAKE BOOSTER PUSH ROD TO OPERATING LEVER CLIP

1966-67 C4AZ2525A..... 2.75



POWER BRAKE BOOSTER SEAL

1965-66 C5ZZ2021..... 9.95

BRAKE PRESSURE DIFFERENTIAL VALVE & WARNING LIGHT SWITCH

1968-69 C8AZ2B264A..... 25.00



ADJUSTABLE DISC BRAKE PROP. VALVE - Compatible with 3/16" & 1/4" brake lines

C5ZZ2B091R..... 49.95
Chrome C5ZZ2B091CHR..... 60.00



BRAKE PEDAL PAD

*1960-65 Auto C0DD2457A..... 9.00
*1960-65 Standard B7A2457A..... 4.50
*1966-70 Standard C5ZZ2457G..... 5.00
*1966-70 Auto C6OZ2457A..... 6.00
1968-70 Disc - Manual C5ZZ2454D..... 10.00
1968-70 Disc - Auto D3ZZ2454A..... 12.00



BRAKE PAD TRIM - STAINLESS STEEL

*1966-70 Standard D1ZZ2A487B..... 9.00
*1966-70 1/2 Auto C6OZ2A487A..... 9.00



BRAKE PEDAL BUMPER

*1960-65 MA7583A..... 3.00



*BRAKE & CLUTCH PEDAL SUPPORT BUSHING

1960-70 1/2 B7AZ2471A..... ea..... 1.00



BRAKE & CLUTCH PEDAL SUPPORT REPAIR KIT

1960-70 1/2 378200K..... 18.95

BRAKE PEDAL SHAFT SPRING CLIP

380699S100..... 3.00



WHEEL HUB ONLY

*1960-65 6 Cyl. C3DZ1107..... 70.00
*1963-70 V8 C5ZZ1107..... 70.00



PLEASE CHECK YOUR CAR BEFORE ORDERING

BRAKE DRUM FRONT



1960-65 9" X 2 1/4" W/O hub BD2640 4 Lug....	65.00
1963-70 10" X 2 1/4" W/O hub BD1634 5 Lug.....	70.00
1966-70 9" X 2 1/4" W/O hub BD2642 4 Lug.....	65.00

REAR

1960-70 9"X1 1/2" BD2641.....	60.00
1960-70 9"X2 1/4" BD2640.....	65.00
1960-70 10"X1 3/4" BD2623.....	65.00
1960-70 10"X2" BD2637.....	80.00

(Width measurements are for shoe size - not drum depth)

*ALSO FITS SOME CONVERTIBLE/ STATION WAGON & RANCHERO



HELPFUL HINT:
PLEASE CHECK WIDTH & SIZE OF YOUR SHOES BEFORE ORDERING - SOME CARS HAVE BEEN CHANGED OVER THE YEARS

*BRAKE SHOES

1960-70 Front 6 Cyl. *R243 2 1/4".....	set.....	35.00
1963-70 Front V8 R154 2 1/4".....	set.....	35.00
1960-70 Rear 6 Cyl. R244 1 1/2".....	set.....	35.00
1963-70 Rear V8 R151 1 3/4".....	set.....	35.00



HARDWARE KITS - Included: return spring, pins, cups & other hardware for both drums - self adjuster not included.

1960-70 6 Cyl. 9" Front/Rear H7047/H7048.....	ea.....	13.00
(For 1960-64 put washers on outside of pin)		
1963-70 V8 10" Front/Rear H7045/H7102.....	ea.....	12.00
1968-70 Disc Front H5504.....		20.00



BRAKE SHOE ANCHOR PIN GUIDE

1965-73 6 Cyl. 9" drums T2028.....	ea.....	2.00
------------------------------------	---------	------

SELF-ADJUSTING KITS - 1 PER WHEEL

1963-70 9" Front/Rear LH/RH H2516/H2517.....	15.00
1962-70 10" Front/Rear LH/RH H2514/H2515.....	12.95

BRAKE SHOE TO CYLINDER LINK

1960 6 Cyl. & 1963-70 V8 B7A2042A.....	5.00
--	------



REAR BRAKE SPREADER BAR

LH 9" - 6 Cylinder T2A642.....	10.50
RH 10" - V8 T2A643.....	10.50
1960-70 9" brake - spring C0DD2601.....	5.00
1963-70 10" brake - spring C2OZ2601.....	3.00

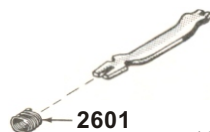

BRAKE HOSES - FRONT

YEAR	Description	LH/RH	PART #	PRICE
1960-64	All	LH/RH	BH22700	26.95
1965-66	All	LH/RH	BH29709	24.00
1967-70	All	LH/RH	BH36549	25.00

BRAKE HOSES - REAR

YEAR	Description	PART #	PRICE
1960-65	All	BH22700	26.95
1966	Sedan	H57540	40.00
1967-70	Sedan	BH36624	39.50
1967-70	Station Wagon	BH36604	CALL



*BRAKE HOSE CLIP

1960 up A7AZ2814A (3 per package).....	2.50
--	------

*WHEEL CYLINDERS - FRONT



YEAR	Description	LH	RH	PRICE
1960-65	All - 6 Cyl	WC36100	WC36101	31.50
1963-65	All - V8	WC36017	WC36018	27.00
1966	Station Wagon - 6 Cyl	WC36017	WC36018	27.00
1966	Sedan - 6 Cyl	WC36100	WC36101	31.50
1966	Station Wagon - V8	WC37118	WC37119	31.50
1966	Sedan - V8	WC36017	WC36018	27.00
1967-70	Sedan - 6 Cyl	WC36100	WC36101	31.50
1967-70	Sedan - V8	WC36017	WC36018	27.00
1967-70	Station Wagon	WC37118	WC37119	31.50
1970 1/2	All	WC36017	WC36018	27.00

*WHEEL CYLINDERS - REAR

YEAR	Description	LH	RH	PRICE
1960-62	Station Wagon	WC37029	WC37029	30.00
1960-65	6 Cyl. -Exc. Conv. & S/W	WC34876	WC34876	25.00
1963-64	6 Cyl. - Conv. & S/W	WC37029	WC37029	30.00
1963-65	V8 - Conv. & S/W	WC17509	WC17510	30.00
1963-65	V8 - Sedan & Hardtop	WC36019	WC36020	27.00
1965	6 Cyl. Conv. & S/W	WC33465	WC33465	27.00
1966-70	All - Station Wagon	WC17509	WC17510	30.00
1966-68	V8 - Sedan	WC36019	WC36020	27.00
1966-70	6 Cyl. - Sedan	WC37108	WC37108	27.00
1969	V8 - Sedan	WC17507	WC17508	30.00
1970	V8 - Sedan	WC17509	WC17510	30.00
1970 1/2	All	WC36019	WC36020	27.00



*BRAKE HOLE ADJUST. PLUG

PE108 (4).....	2.00
----------------	------



BRAKE HUB GREASE CAP

*1960-65 6 Cyl. C3DZ1131A.....	5.00
*1963-70 V8 B5A1131A.....	4.50

SPINDLE NUT & WASHER

6 Cylinder C0DZ1195.....	8.95
--------------------------	------

*INNER FRONT WHEEL BEARINGS & RACE

1963-65 V8 A6.....	15.00
1960-65 6 Cyl. A4.....	11.25
1966-70 All A6.....	15.00
1970 After 1/12/70 A13....	11.00



*OUTER

1963-65 V8 A2.....	11.00
1960-65 6 Cyl. A1.....	10.00
1966-70 All A2.....	11.00
1970 After 1/12/70 A12.....	10.50

*FRONT WHEEL GREASE SEAL

1960-65 6 Cyl. 7994S.....	14.00
1966-UP 6 Cyl. 6815.....	5.25
1963-70 V8 6815.....	5.25

OUTER WHEEL BEARING RETAINER WASHER

*1963-69 C2AZ1195A V8.....	12.50
----------------------------	-------

COTTER PIN

*All #4773 1 X 1/8 Diameter.....	35
----------------------------------	----



REAR BRAKE LINE FITTING

1960-63 Comet 8A2074.....	11.25
---------------------------	-------



*Also fits Comet

PLEASE CHECK YOUR CAR BEFORE ORDERING

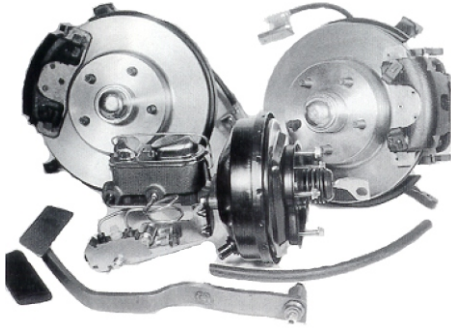

FRONT DISC BRAKE CONVERSION KITS

Conversion kit includes everything necessary to totally convert a production drum brake equipped car to factory 4-piston disc brakes. The calipers are manufactured with stainless steel pistons, stainless steel cross-over tube, and stainless steel bleeders. All parts are NEW, either from Ford, or made to Ford prints. Minimum 14 X 7 wheels

1963-66 Non-power, single chamber master cylinder, V8 only, 4 piston calipers A120..... 995.00
 1963-66 Non-power, dual master cylinder, V8 only, 4 piston calipers A120D..... 995.00
 1967 Non-power, dual master cylinder, 4 piston calipers, - 6 cylinder requires new spindles and tie rods - call A121.....1095.00

1968-70 Power booster, new spindles, single piston calipers A132..... 1250.00
 1968-70 Non-power, new spindles, single piston calipers A132-1..... 995.00



4 LUG FRONT DISC BRAKE CONVERSION KIT

1963-66 14"X7" wheel minimum - bolts to original spindle - kit includes rotors, calipers, master cylinder, flex hoses and all necessary installation hardware - Incl. new front heavy duty hubs. A120-4..... 895.00

REAR DISC BRAKE CONVERSION KITS

123 piece kit employs 1984-86 Mustang SVO rear calipers with integral parking brake mechanisms and unidirectional vented rotors to completely upgrade your stopping power with a 4 wheel disc brake system. The entire project using our kit, complete with full instructions, can be accomplished in approximately 8 hours, without special tools, cutting or welding. A companion kit for the 9", 31 spline rear axle, using 1/2" diameter bolts for the housing flange (instead of 3/8" for the standard kit) and matching mounting brackets, is also available from stock. Be sure to specify axle size when ordering. Calipers with stainless steel pistons are available as an option. All parts are new; no core exchange is required.
 1963-70 A111-2..... 825.00

POWER BRAKE BOOSTER

New 7" diameter mini-booster bolts to stock location. Includes hard-to-find firewall bracket and new master cylinder. Single reservoir master cylinder.
 1964-65* BM1504K - Specify automatic or manual transmission.. 425.00

POWER BRAKE BOOSTER - DUAL MASTER

CYLINDER - BOOSTER IS ONLY 2" THICK - COMES WITH AN ADJUSTABLE ROD FOR PEDAL HEIGHT - OVERALL ONLY 10"
 Must cut hole in firewall. Dual reservoir master cylinder & booster.
 1960-65 #9782 - + S & H..... 369.00
 1967-70 **THE UNIQUE DESIGN OF THESE MOUNTING BRACKETS LIFTS THE BOOSTER SO THAT YOU CAN USE THE TALL VALVE COVERS** #9784 - + S & H..... 369.00

BRAKE LIGHT SWITCH "T" KIT

For use with disc brake conversion kits. Use in-line - pressure operated switch.
 HW2003..... 28.00



DISC BRAKE PADS

1967 D11..... 25.00
 1968-70 D34..... 25.00

DISC BRAKE CALIPER PIN

1968-70 H5000-2..... 4.00

DISC BRAKE CALIPER SEAL KIT

1968-70 WC191D..... 9.45

DISC BRAKE BACKING PLATE GASKET

1968-71 C8OZ2B160A..... 3.95

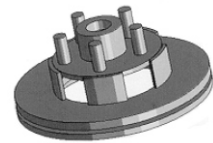

DISC BRAKE ROTORS

1967 D6004..... 99.00
 1968-69 D6006..... 79.00

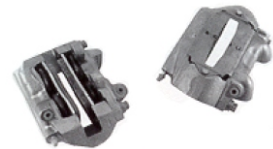

DISC BRAKE CALIPERS - SINGLE PISTON

1968-69 44012 - EXCHANGE..... 95.00

OVERSIZE SHIPPING APPLIES TO ALL DISC BRAKE KITS

STREET ROD PARTS NOW AVAILABLE!
 GRIFFIN RADIATORS, MARCH PULLEY SETS, PAINLESS WIRING, LOKAR DIPSTICKS/ACCELERATOR LINKAGE/TRANSMISSION LINKAGE & FLOOR SHIFTERS, FLAMING RIVER STEERING COLUMNS - JUST GIVE US A CALL -

*Also fits Comet

PLEASE CHECK YOUR CAR BEFORE ORDERING

***FRONT BRAKE LINE - S/S SPECIAL ORDER**

YEAR	PART #	PRICE	STAINLESS	PRICE
1960-63 2 pc.	LKT6001	45.00	LKT6001S	65.00
1964-65 2 pc.	LKT6301	45.00	LKT6301S	65.00
1966 Drum	LKT6601	45.00	LKT6601S	70.00
1969 Drum	LKT6901	65.00	LKT6901S	95.00

***LONG BRAKE LINE - S/S SPECIAL ORDER**

YEAR	PART #	PRICE	STAINLESS	PRICE
1960-63	LIN6001	50.00	LIN6001S	75.00
1963 Convertible	LIN6002	50.00	LIN6002S	75.00
1960-63 Comet	LIN6003	50.00	LIN6003S	75.00
1964-65 Hardtop	LIN6301	50.00	LIN6301S	75.00
1964-65 Conv.	LIN6302	50.00	LIN6302S	75.00
1964 S/W/Ranch.	LIN6303	50.00	LIN6303S	100.00
1965 S/W/Ranch.	LIN6303	50.00	LIN6303S	100.00
1966 All	LIN6601	50.00	LIN6601S	75.00
1964-65 Comet HT	LIN6404	50.00	LIN6404S	75.00

***REAR END HOUSING BRAKE LINE - S/S SPECIAL ORDER**

YEAR	PART #	PRICE	STAINLESS	PRICE
1960-63 6 Cyl. 2 pc.	LRA6001	39.00	LRA6001S	60.00
1963 V8 2 pc.	LRA6303	39.00	LRA6303S	60.00
1964-65 6 Cyl. 2 pc.	MHB002	30.00	MHB002S	45.00
1964-65 V8 2 pc.	MHB001	30.00	MHB001S	45.00
1966 All	LRA6601	39.00	LRA6601S	60.00
1969 All	LRA6901	39.00	LRA6901S	60.00

***BRAKE LINE SET - SPECIAL ORDER**

1960-63 Ranchero Man. drum	FNB6001	145.00	S/S	175.00
1966 Ran Man. drum - 9" rear	FNB6601	165.00	S/S	195.00
1966 Car Man. Drum	FFB6601	145.00	S/S	175.00
1967-70 Car Man. Drum	FFB6701	155.00	S/S	185.00

*Oversize shipping



(NOT EXACT - MAY NOT USE ALL PIECES)

BRAKE & GAS LINE CLIP SET 380374KIT..... 15.00



BRAKE LINE RUBBER GROMMET PE141 (2)..... 2.00

BRAKE HARDWARE - CONCOURS

Axle retaining plates - nuts only	AMKK663	7.30
Axle retaining plates - 6 Cyl. "T" bolts & nuts	AMK1523	22.47
Axle retaining plates - V8 "T" bolts & nuts	AMK1439	20.00
Brake cable to body	AMK573	7.49
Brake drum retainers - does 2 drums	AMK579	4.28
Brake hose brackets to body - front	AMK1616	14.98
Master cylinder - w/o power brake	AMK1431	5.62
Parking brake control	AMK800	8.56
Wheel cylinders (2) V8	AMK356	4.00
Wheel cylinders (2) 6 Cyl.	AMK1772	6.42

HELPFUL HINT:

BE SURE TO PULL FROM BOTH SIDES OF LEVER TO AVOID BREAKING HANDLE!



***PARKING BRAKE HANDLE**

1960-65 (Hole is drilled off center for Falcon) C0DZ2760B..... 8.00

LOCK CLIP FOR PARKING BRAKE LEVER

*1960-70 91A2106..... 1.00



PARKING BRAKE CABLE RETAINER CLIP

1963-UP 383475-S100..... 3.00

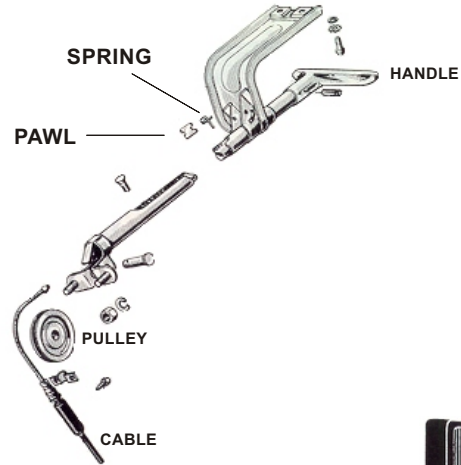

EMERGENCY BRAKE PAD

1966-70 1/2 C6OZ2454A..... 9.00



***PARKING BRAKE EQUALIZER ROD**

All B7A2628B - 7 1/4"..... 10.00
All B7A2628A - 12"..... 10.95



PARKING BRAKE RATCHET SPRING

*1960-65 OM2788R..... 4.00

PARKING BRAKE CABLE CONNECTOR

*1966-70 C6OZ2A790A..... 8.00

PARKING BRAKE PAWL

1960-65 OM2786..... 12.00

PARKING BRAKE CABLE PULLEY

*1960-65 OM2804..... 21.95



PARKING BRAKE CABLE EQUALIZER

*1960-65 C0DD2A602AR..... 15.00
1966-70 C6OZ2A602A..... 15.00



BRAKE CABLE - FRONT

1960-61 Before 5-1-61	S2043	45.00
1960-61 S. W. Bef. 5-1-51	S2089	45.00
1961-65 All except conv.	S2261 Also fits 63-65 Comet	45.00
1963-65 Convertible	S2474 Also fits 64 & 65 Comet Conv	60.00
1966-67 All	S2470	45.00
1968-70 All	S2469	45.00



BRAKE CABLE - REAR

1960-61 6 Cyl. Before 5-1-61 - Sedan - 151 5/16"	S2191	55.00
*1960-61 6 Cyl. Before 5-1-61 - SW - 165 1/2"	S2105	60.00
*1961-63 & 63 Comet 6 Cyl. After 5-1-61 - Exc. Conv. - 151 5/16"	S2191	55.00
1963 6 Cyl. Convertible - 132"	S2505	50.00
1963 8 Cylinder - Convertible - extra long - 132"	S2505	50.00
1963 8 Cylinder - Exc. Convertible - 151 5/16"	S2269	50.00
1964-65 & 64 Comet 6 Cylinder - Exc. Conv. - 152 5/16"	S2473	60.00
1964-65 6 Cylinder - Convertible - 132"	S2505	50.00
1964-65 & 64 Comet 8 Cylinder - Exc. Conv. - 152 5/16"	S2262	65.00
1964-65 8 Cylinder - Convertible - Not Comet 132"	S2505	50.00
1966-70 170"	S2503	55.00
1966-70 Station Wagon/Ranchero - 176"	S2472	55.00

* Also fits Comet